

NOTES:

1. K_t AND K_e BASED ON PEAK SINUSOIDAL DRIVE
2. 8 POLE DESIGN
3. OPTION 1.5 N-m FAIL SAFE BRAKE, 24 VDC, ADD 70 MM TO LENGTH

PART REVISION HISTORY

REV.	DESCRIPTION	ECO	DWN	CHKD	DATE

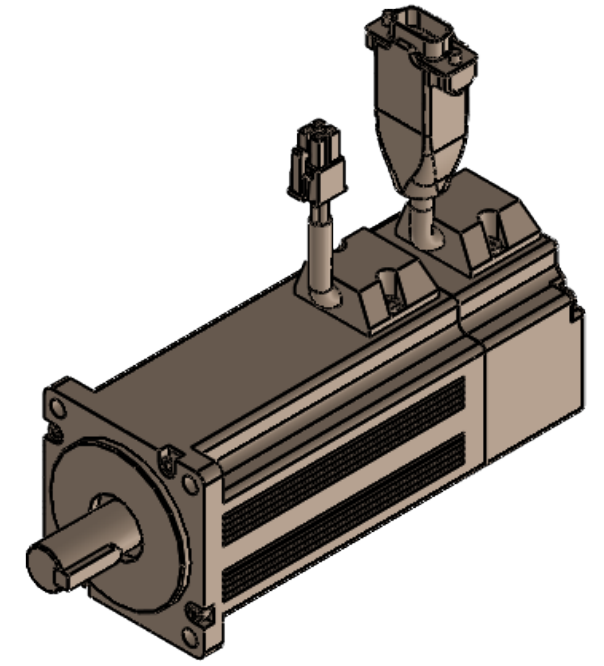
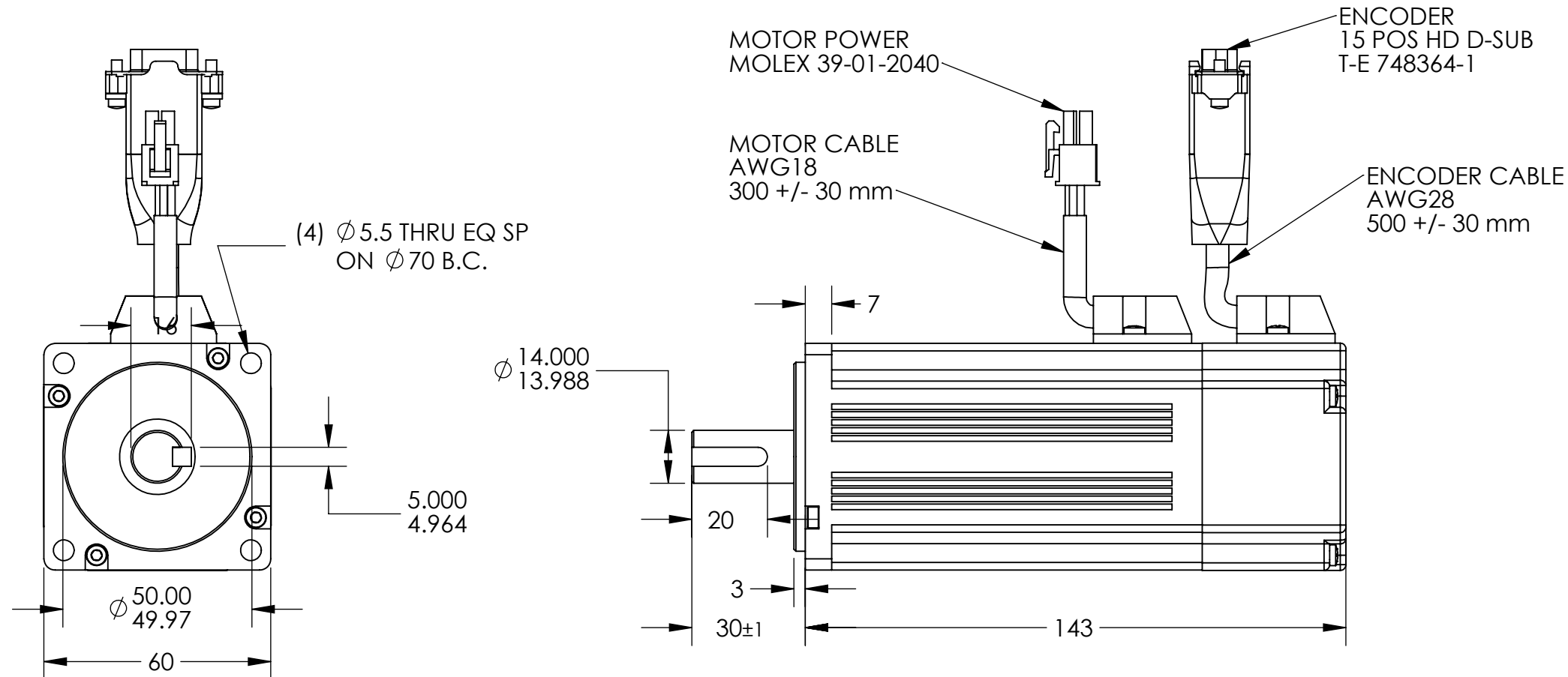

ENCODER SPECIFICATIONS	
TYPE	OPTICAL
OUTPUT TYPE	LINE DRIVER
LINE COUNT	5000
GATED	A / B AT 90 DEGREE
INPUT VOLTAGE	5 VDC +/- 5%
CURRENT	55 mA TYPICAL

Motor leads		
Pin	Color	Function
1	Yellow	Phase U
2	Green	Phase V
3	Blue	Phase W
4	GRN/YEL	CASE

MOTOR PARAMETERS				
		MP60-3A	MP60-3B	MP60-3C
SUPPLY VOLTAGE	VDC	48	72	160
RATE SPEED	RPM	4000	4000	3000
RATED STALL TORQUE	N-m	1.3	1.3	1.3
POWER @ RATED SPEED	WATTS	400	400	400
PEAK TORQUE	N-m	4.1	4.1	3.9
CONTINUOUS CURRENT RMS	AMPS	12.7	7.6	3.4
PEAK CURRENT RMS	AMPS	24.5	22.8	10
VOLTAGE CONSTANT, K_e rms	V/KRPM	7.8	13	30
TORQUE CONSTANT, K_t rms	N-m/A	.0745	.124	0.38
RESISTANCE	OHM	.28	0.44	4.1
INDUCTANCE	mH	.33	0.48	4
MOMENT OF INERTIA	Kg-cm ²	0.29	0.29	0.29
INSULATION CLASS		F	F	F

FEEDBACK		
Pin	Color	Function
1	Red	5 vdc
2	Black	GND
3	Brown	Chl A
4	White	Chl A/
5	Blue	Chl B
6	Green	Chl B/
7	Orange	Index
8	Yellow	Index/
9		
10		
11	Violet	COMM A
12	WHT/BRN	COMM B
13	WHT/ORG	COMM C
14		
15	Shield	Shield

NOTICE ON REPRODUCTIONS
 THIS DRAWING THE DESIGN AND THE PATENTS IT COVERS ARE THE PROPERTY OF CYMATIX, INC., OR THEIR CUSTOMERS. THEY WILL NOT BE REPRODUCED, COPIED, LOANED, EXHIBITED NOR USED EXCEPT IN THE LIMITED WAY AND THE PRIVATE USE PERMITTED BY THE CONSENT GIVEN BY THE LENDER TO THE BORROWER.

TOLERANCES UNLESS OTHERWISE SPECIFIED (U.O.S.)
 DECIMALS .XX = $\pm .01$
 .XXX = $\pm .005$
 .XXXX = $\pm .0005$
 C'BREAKS .010/.020
 FILLETS 1/64
 .020 MAX
 FRAC. 1/64
 MACH. FIN. 125/
 ANGLES 1°



TITLE: BL MOTOR, 60 mm, 5000 ppr

DRAWN	JPB	DATE	06/30/22	SIZE	B	PART NO.	MP60-3x-MX5000-CN-001	PART REV.	A
CHECKED	TPB	DATE	06/30/22	SCALE:	NONE	SHEET 1 OF 1	DWG.NO.	R	